

Damstra Technology – DT-MK2 Terminal Series Installation Guide



Damstra Technology – DT-MK2 Terminal Series Installation Guide

DT – MK2

Specifications



Enclosure	Custom Made Enclosure with Powder coat finish.
RFID	Dual Band Card Reader
Display	<ul style="list-style-type: none"> ▪ 12.1" XGA Industrial ▪ Resistive Touch Display with Inbuilt Industrial PC
Camera	720p Camera
Optional Extras	<ul style="list-style-type: none"> ▪ 4G Modem w/Antennae ▪ Alcolizer ▪ Thermal / Facial Recognition Camera

Device Type	Power Requirements	Data Connection
DT-MK2	<ul style="list-style-type: none"> ▪ X2 110-240v Double Outlet General Purpose Outlet ▪ (Inside Unit, with 4 way tagged power board) <p>*GPO requires an electrician to install it.</p>	Ethernet / WIFI or 4G

Damstra Technology – DT-MK2 Terminal Series Installation Guide

GPO Mounting Location

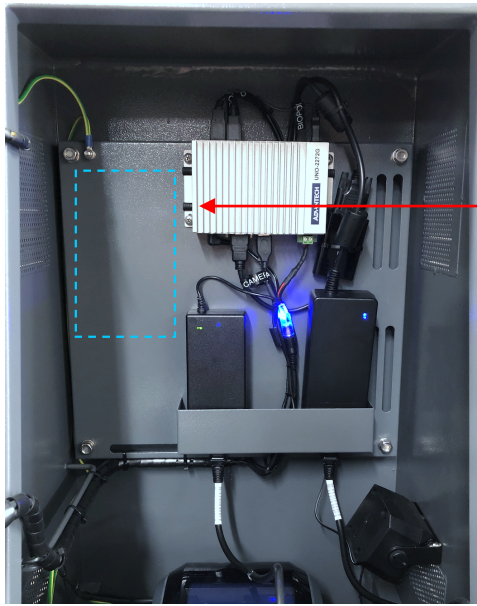

The DIN Rail and Clipsal GPO are mounted inside the Damstra Terminal, to prevent users from being able to tamper with the equipment.

5 are recommended, however if permitted, 4 can be installed and the use of a Test and Tagged Powerboard can be used.

Recommended Components:

Clipsal Part # 4PSO10

Description: 250V 10A 3 Pin socket outlet 2.5 modules wide
Qty: 5

DIN Rail: As Required

Figure 2. GPO mounting location

DT-MK2P GENERAL ARRANGEMENT AND LAYOUT

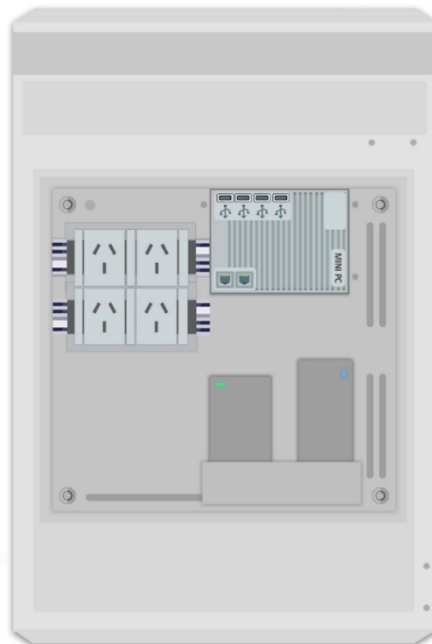
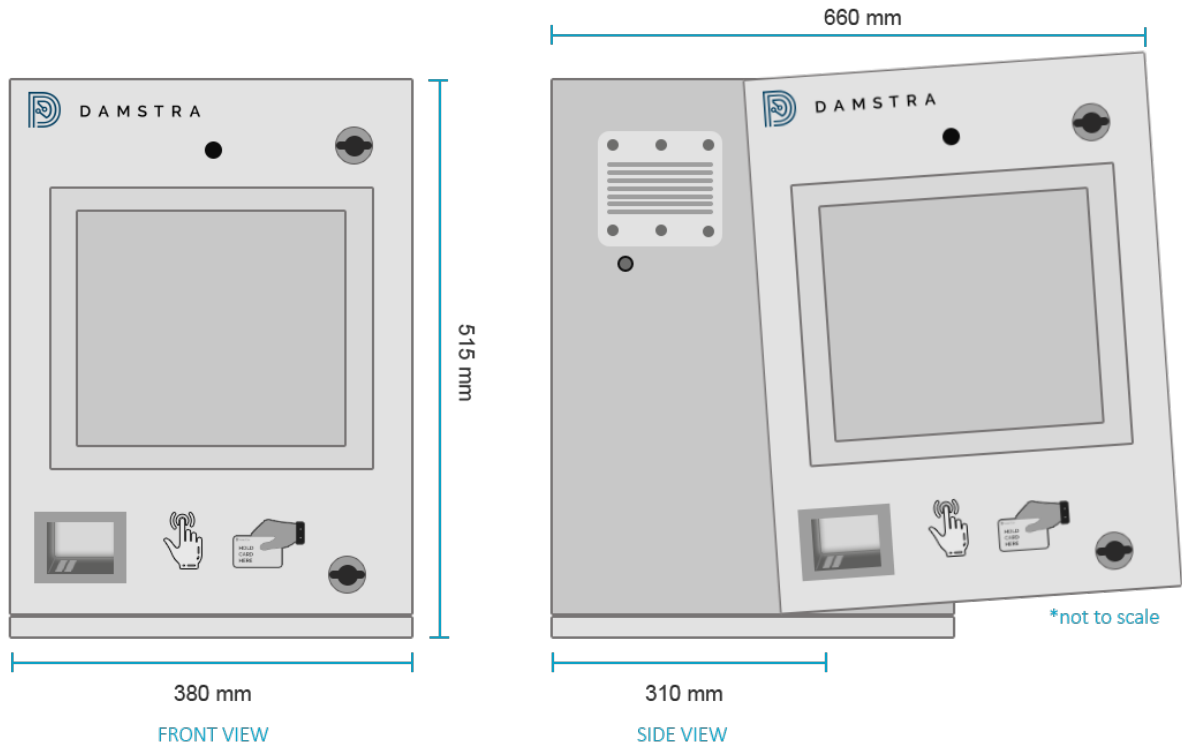

Figure 2a. Illustration of DIN Rail GPO positioning

Damstra Technology – DT-MK2 Terminal Series Installation Guide

Dimensions and Installation Layout



Note:

If you are adding a WM4 Alcolizer, please refer to Page 9 for further instructions.



Damstra Technology – DT-MK2 Terminal Series

Installation Guide

Electrical / Environmental and Connectivity

A suitable location should:

- be out of the weather (rain, wind and sun)
- provide enough wall mounting space for all units to be mounted
- provide sufficient 3G mobile service where required and
- be a suitable location for the workforce to find and access the system easily.

Consideration should be given to the ambient air temperature. If ambient temperatures exceed 50 degrees Celsius alternate locations should be found.

Note:



Failure to mount out of sunlight or in weather affected areas will void all maintenance warranties and any cost of repair will be charged back to you.

The unit can be mounted to most surface types; however, weight and usage needs to be considered for hollow-type walls. Suitable mounting components should be used to ensure a safe and secure installation. Typically, this may include the use of **UniStrut** or similar mounting systems. On solid wall types (metal, brick, etc.), the units may be attached directly to the wall using suitable mounting methods.

Mounting Height

The terminal itself is recommended to be **mounted with the top of the unit 160cm – 170 cm from the ground**. This height has been found to provide a usable interface and comfort factor for persons, covering the widest range of person's heights. This is flexible and can be adjusted at sites discretion.

Damstra Technology – DT-MK2 Terminal Series Installation Guide

Mounting the Terminal

The terminal attaches to the wall via 4 anchors, located in each corner of the unit. **The holes for these anchors points are ONLY to be drilled as per Figure 3.**

Any holes required for conduit **MUST** only be drilled from the underside of the cabinet at the rear. This typically includes power and data cabling, as well as any cabling associated with an alcoliser if utilised.

Care should be taken that cables and conduits entering from the bottom rear of the enclosure do not affect the printer drawer operation. There is a **35 mm gap** at the rear of the drawer to allow for conduits and cabling as shown in **Figure 4.**

Do not drill any additional holes in any other areas of the enclosure. Failure to comply with this will result in additional charges upon return of the equipment.

Mount the unit to the wall or mounting equipment using appropriate screws/bolts. Tighten and ensure the unit is stable and secure.

Clearance Required

Adequate clearance is required if there is any other device installed in the same location e.g. Alcolizer. The terminal door needs adequate clearance for it to be opened.

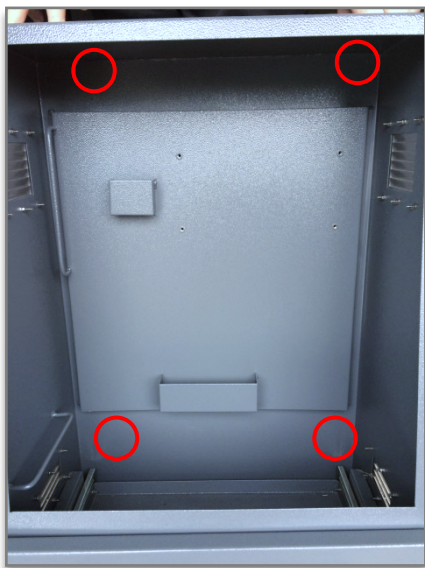

Figure 3. Anchor points to drill holes

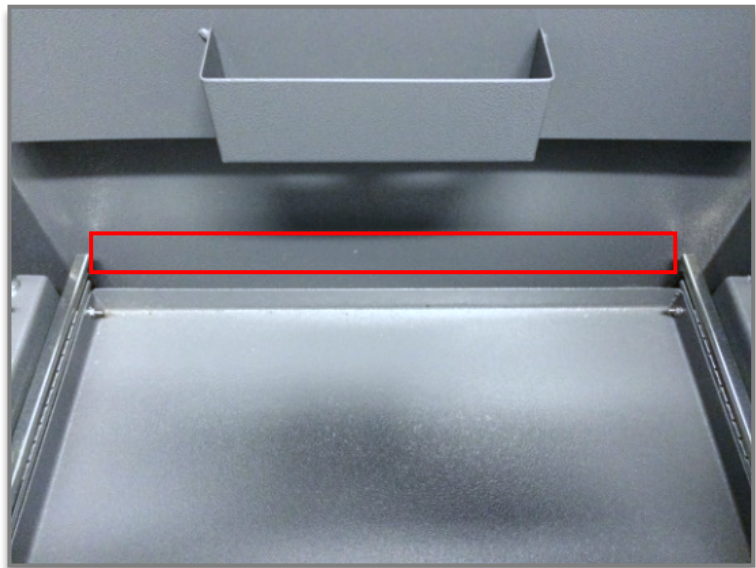

Figure 4. Gap at the rear drawer

Damstra Technology – DT-MK2 Terminal Series Installation Guide

Reminders

1. To open the cabinet, use the keys provided; ensure to lock it again after the installation is complete.
2. Make sure that all plugs inside the cabinet have power to them.
3. As soon as power is turned on, everything will boot up automatically and the terminal will be ready to use in a few minutes.

Damstra Technology – DT-MK2 Terminal Series Installation Guide

DT – MK2P

Specifications



Enclosure	Custom Made Enclosure with Powder coat finish.
RFID	Dual Band Card Reader
Display	<ul style="list-style-type: none"> ▪ 12.1" XGA Industrial ▪ Resistive Touch Display with Inbuilt Industrial PC
Camera	720p Camera
Additional Part	Zebra GX420d Thermal Printer with Auto Cutter
Optional Extras	<ul style="list-style-type: none"> ▪ 4G Modem w/Antennae ▪ Alcolizer ▪ Thermal / Facial Recognition Camera

Device Type	Power Requirements	Data Connection
DT-MK2P	<ul style="list-style-type: none"> ▪ Refer to next page 	Ethernet / WIFI or 4G

Damstra Technology – DT-MK2 Terminal Series Installation Guide

GPO Mounting Location

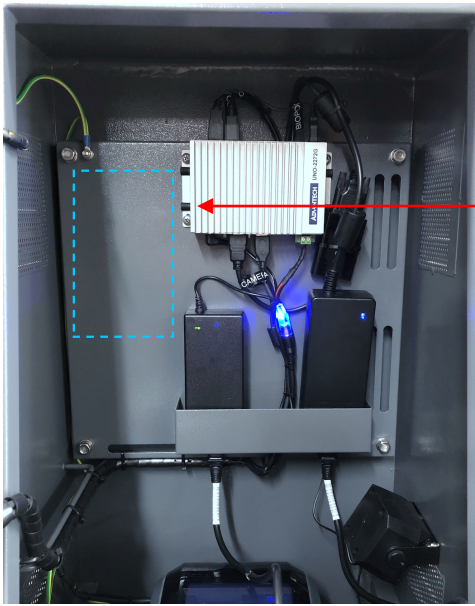

The DIN Rail and Clipsal GPO are mounted inside the Damstra Terminal, to prevent users from being able to tamper with the equipment.

5 are recommended, however if permitted, 4 can be installed and the use of a Test and Tagged Powerboard can be used.

Recommended Components:

Clipsal Part # 4PSO10

Description: 250V 10A 3 Pin socket outlet 2.5 modules wide
Qty: 5

DIN Rail: As Required

Figure 2. GPO mounting location

DT-MK2P GENERAL ARRANGEMENT AND LAYOUT

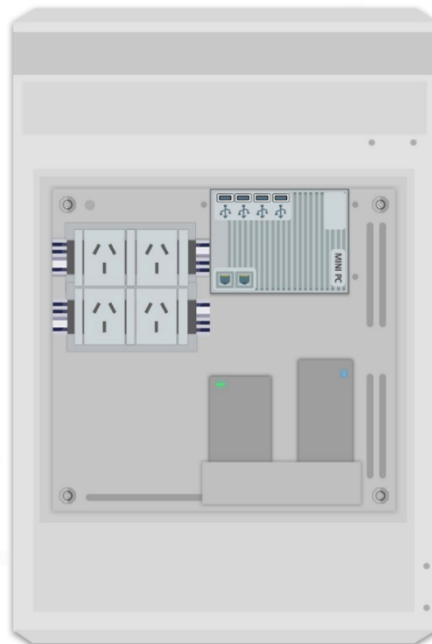

Figure 2a. Illustration of DIN Rail GPO positioning

Damstra Technology – DT-MK2 Terminal Series Installation Guide

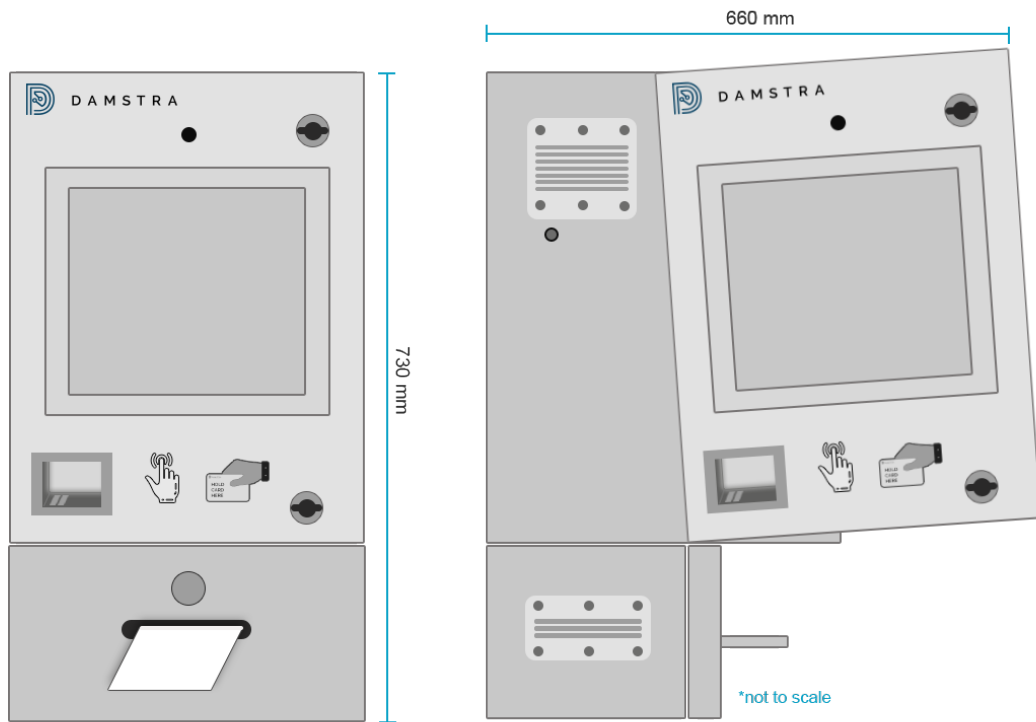

Figure 3. Dimensions and Installation Layout

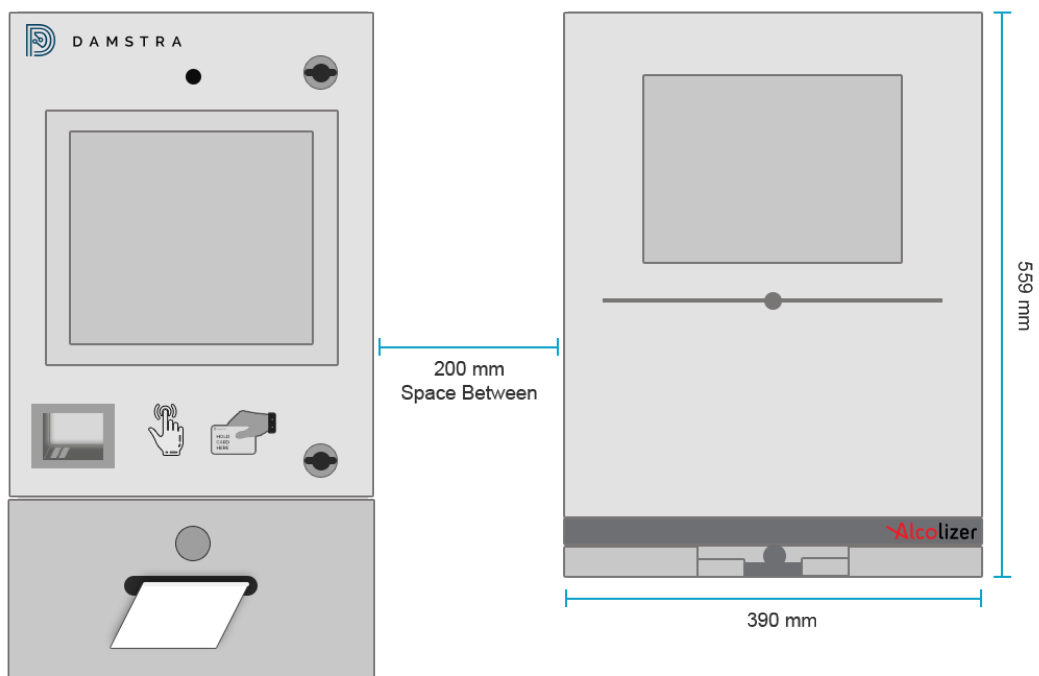

Figure 3a. Alcolizer positioning and distance between terminal

Damstra Technology – DT-MK2 Terminal Series Installation Guide

Electrical & Alcolizer Communication Cable Location

As each installation is different, we recommend that electrical cabling is entered through the left-hand side (Red Circle) and the Alcolizer serial cable from the right-hand side (Green Circle) on the base of the cabinet.

We recommend that after you drill the holes out, appropriate cable glands be inside to ensure vermin cannot enter the terminal.

In our experience, electricians often cut and splice the COM cable (which should be avoided at all costs), If splicing occurs this would must be carried out professionally and all joins must be soldered and tested.

The Alcolizer should be installed as per Diagram 3a with the displays aligning, but both units at an appropriate height so that personnel can use the system safely.

Note:



- This is not a regular serial cable. It is an RS232 Null Modem COM Cable.
- The Damstra Technology Terminal and the WM4 Alcolizer will not communicate without this specific type of COM Cable.
- If utilising the Splice and Join method (not recommended) please use the Yellow, Blue & Red wires.

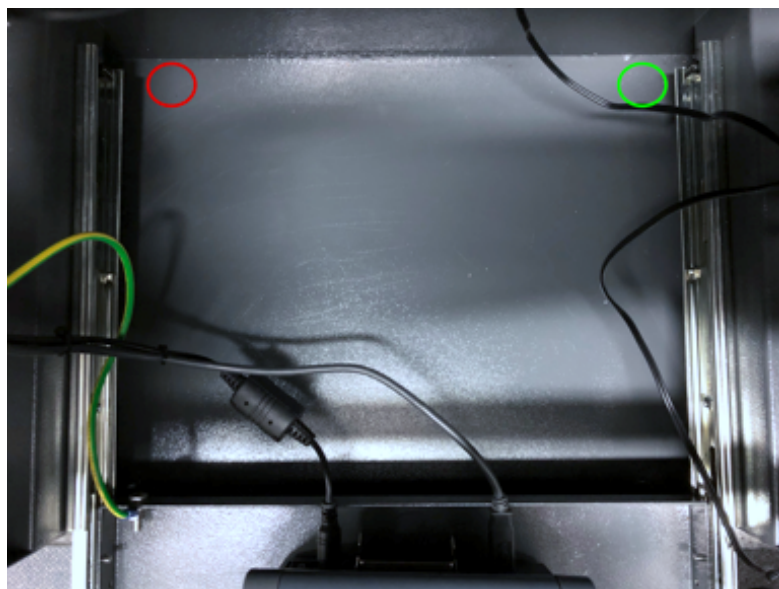

Figure 3b. Electrical & Alcolizer Cable Holes

Electrical / Environmental and Connectivity

A suitable location should:

- be out of the weather (rain, wind and sun)
- provide enough wall mounting space for all units to be mounted
- provide sufficient 3G mobile service where required and
- be a suitable location for the workforce to find and access the system easily.

Consideration should be given to the ambient air temperature. If ambient temperatures exceed 50 degrees Celsius alternate locations should be found.

Note:



Failure to mount out of sunlight or in weather affected areas will void all maintenance warranties and any cost of repair will be charged back to you.

The unit can be mounted to most surface types; however, weight and usage needs to be considered for hollow-type walls. Suitable mounting components should be used to ensure a safe and secure installation. Typically, this may include the use of **UniStrut** or similar mounting systems. On solid wall types (metal, brick, etc.), the units may be attached directly to the wall using suitable mounting methods.

Mounting Height

The terminal itself is recommended to be **mounted with the top of the unit 160cm – 170 cm from the ground**. This height has been found to provide a usable interface and comfort factor for persons, covering the widest range of person's heights. This is flexible and can be adjusted at sites discretion.

Mounting the Terminal

The terminal attaches to the wall via 4 anchors, located in each corner of the unit. **The holes for these anchors points are ONLY to be drilled as per Figure 4.**

Any holes required for conduit **MUST** only be drilled from the underside of the cabinet at the rear.

This typically includes power and data cabling, as well as any cabling associated with an alcoholiser if utilised.

Damstra Technology – DT-MK2 Terminal Series Installation Guide

Care should be taken that cables and conduits entering from the bottom rear of the enclosure do not affect the printer drawer operation. There is a **35 mm gap** at the rear of the drawer to allow for conduits and cabling as shown in Figure 5.

Do not drill any additional holes in any other areas of the enclosure. Failure to comply with this will result in additional charges upon return of the equipment.

Mount the unit to the wall or mounting equipment using appropriate screws/bolts. Tighten and ensure the unit is stable and secure.

Clearance Required

Adequate clearance is required if there is any other device installed in the same location e.g. Alcolizer. The terminal door needs adequate clearance for it to be opened.

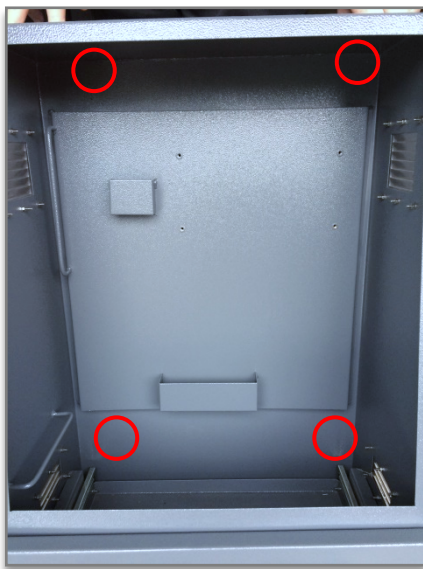

Figure 4. Anchor points to drill holes

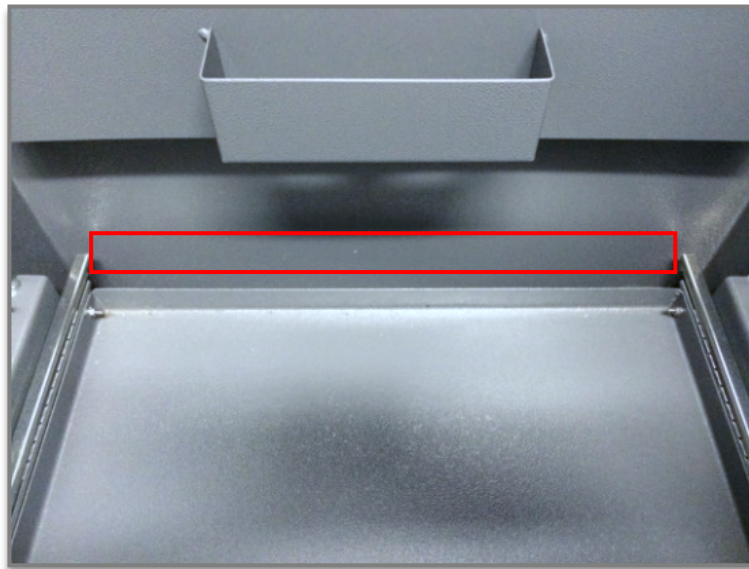

Figure 5. Gap at the rear drawer

Reminders

1. To open the cabinet, use the keys provided; ensure to lock it again after the installation is complete.
2. Make sure that all plugs inside the cabinet have power to them.
3. As soon as power is turned on, everything will boot up automatically and the terminal will be ready to use in a few minutes.